

9. Warranty terms

"Producer" - "Vector-08" company

"Seller" - organization or individual - entrepreneur who made an a cooperation agreement with "Vector-08" company

."Customer" - individual person or legal entity who has purchased concrete mixer

·Period of concrete mixer operation is 4 years. Warranty period of operation 2,000 hours since the start of the work, but not more than 1 year from the date of sale.

Separately, we provide 1.5 years warranty for the metal composite crown.

The warranty does not apply if you misuse the concrete mixer (paragraph 1 passport) as well as violation of rules for use, that given in the passport.

The warranty is void if concrete mixer passport are lost or if it have incorrect contents (no "producer" stamp, no "Seller" mark, no date of sale)·

After purchasing concrete mixer by "Customer", "Seller" makes a mark in the passport, from that point complaints on the contents are not accepted.

Warranty provided in this order:

a) Receiving reclamation from the "Customer" by "Seller"

b) "Seller" are making the report of the fault detection in free form and sending it to the "producers"

c) The producer at its discretion, decides on opportunities and places of repair

d) The decision on warranty replacement of the concrete mixer accepted by "producer" within 3 business days after receiving report of the fault detection from the "Seller".

Addition 1

Adjust the drive belt tension.

Concrete mixers uses the belt drive for rotating tank. Over time the belt tension may become weakened and lead to slippage on the pulley. To prevent this, adjust the belt tension (Figure 1)

1. Loosen the bolts (1)

2. Push up on top of the plastic housing (2) to the necessary stop and in this state, tighten the screws (1) fastening the housing.

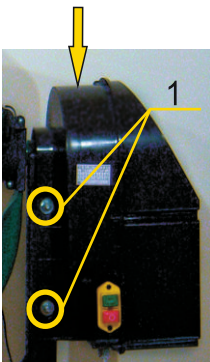
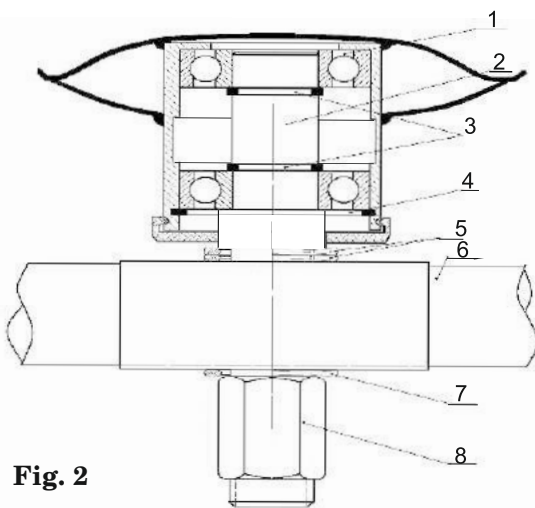

Fig. 1

Addition 2



The lower bearing cup node

1. Ball Bearing 6007
2. The axis of the tank
3. Retaining ring
4. Retaining ring
5. Adjusting washer
6. Arc
7. Grover Washer
8. Screw nut

Concrete mixer uses a gearing the gear - the crown. Over time, this gearing needs to be regulated by using washers 5 (Figure 2) removing one or two washers, according to the needs. The gap between gearing must be a three-quarters of the gear tooth.

Fig. 2

Addition 3 (Fig.3)

Instructions for concrete mixer assembly

For of concrete mixer assembly you will need:

Ring spanners or ratchet wrench for screw nut M8 - 2 pcs.

Phillips screwdriver with a length of at least 120 mm.

The ring puller pliers for external retaining rings

1. Put the transport wheel (7) on the wheel axle and fasten retaining rings A26

2. Attach the pipe - connection (3) to the rack (1) and (2) using the nut, grover, washers and bolts as you see in it at the Figure 3

3. The tank assembled with an arc (4), set on a rack according to Figure 4

4. Use clamps (8) to lock the arc cup to the frame racks (1, 2) and fix it with bolts, washer and screw nut.

5. Assembling the plastic motor housing

5.1. Unscrew the housing cover screws (3) See below. "Instructions for parts replacement" (Figure 3) and remove the housing covers (5.2) Figure 3

5.2. Put on a rack (1) the motor housing (5.1) in to combination with rack mounting holes and housing and affix the bolted connection slightly tightening it.

⚠ Make sure that housing (5.1) was placed strictly in to the parallel to the rack (1)

5.3. Affix the pulley (2) Fig. 3 "Instructions for parts replacement" by the side with the rigid ribs inside until it stops and put the retaining ring.

5.4. Put the belt on the motor shaft and pulley, make belt tension (Addition 1)

⚠ Make the belt tension without cover (5.2) make it with your hands pressing to hard edge (inside) of the motor housing (5.1).

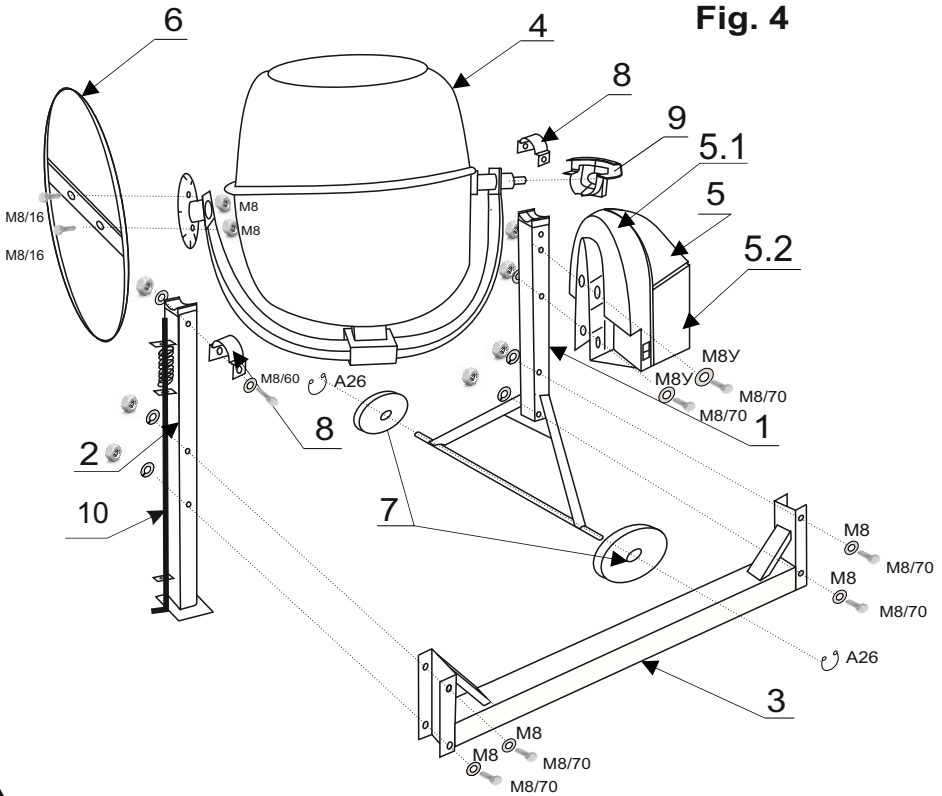
Fig. 4

5.5. These works are carried out in the place that is protected from rain and outsiders. Do not touch the parts inside the motor housing!

After tensioning the belt, turn on the concrete mixer and visually inspect the work of the belt, it should not touch the housing wall and should not be displaced along the axis of the motor or pulley. In case if you notice it displacement it is indicates incorrect installation of housing (5.1) on the rack (1). In this case, repeat the operation of paragraph 5.2 of this manual.

5.6. Attach the housing cover (5.2) to the motor housing (5.1) with screws.

5.7. Attach the steering wheel (6) with bolts and screw nuts according to the picture.



Attention! Before operating, read the passport!

You can watch video instructions how to assembly concrete mixer on our web site www.vector-ua.net.

Completionation figure 3

1 Big Rack

2. Small Rack

3. Pipe-connection

4. Tank in assembly

5. Concrete mixer motor housing in assembly (5.1- housing, 5.2- cover)

6. Steering wheel

7. Transport wheel - 2 pcs.

8. Clamp - 2 pcs.

9. Gear protection

10. Tank detent

without numbering: pulley, belt, passport.

Ironwares:

Bolt M8 / 16 - 2 pcs; M8 / 60 - 2 pcs;

M8 / 70 - 6 pcs.

Grover M8 - 4 pcs.(for pipe3!)

Screw nut M8 - 6 pcs.

Washer M8 (y) - 4 pcs.

Washer M8 - 12 pcs.

Retaining ring A15 - 1 pcs.

A26 - 2 pcs.

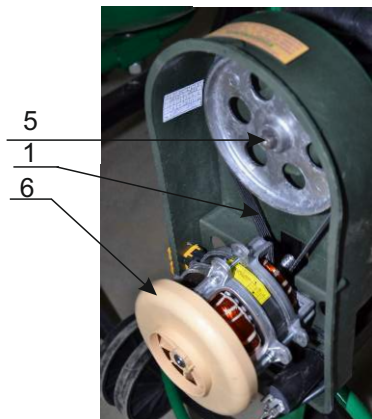

Fig. 5

Instructions for parts replacement



Carry out the work with the disconnected power plug from the power source!

1. Replacement of the belt 1 (Figure 1)

Remove the cover of the housing 2 (Figure 6) by loosening screws 3.

1.2. Loosen the bolts 4

1.3. Remove the old belt.

1.4. Put on the new belt

1.5. For the belts tensioning see (Addition 1)

1.6. Put on the cover of the housing and tighten the screws.

2. The replacement of the gear with an axle (for specialists)

2.1. Remove the tank mixer, unscrewing the screw nut M30 see. (Addition 2 p.8)

2.2. Fulfill the requirements of p.1.1, 1.2, 1.3

2.3. Remove the retaining ring 1 (Figure 7),

with axis.

2.5 Using a metal pipe about 20-22 mm., you have to knock out the bearing 3 to the side of the pulley and remove bearing and anti-duster of the axle.

2.6. With the new bearings in reverse order gather the node. Anti-duster has a ledge that has to sit in to the groove in the gear. After press-work of the axis with bearings in the tube, put on the side of the shell bearing some grease "Litol-24" or analog. With your hands it should be easy for axis to rotate in the pipe. In case if you scroll and you feel like bearings jamming - it can indicate about incorrect position of bearings or it defects. Disassemble the node and replace it if it is necessary with intact bearing.

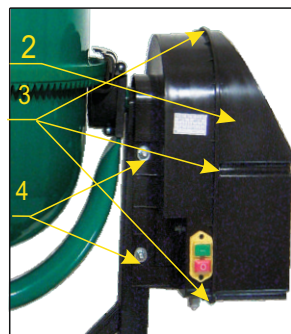

Fig. 6

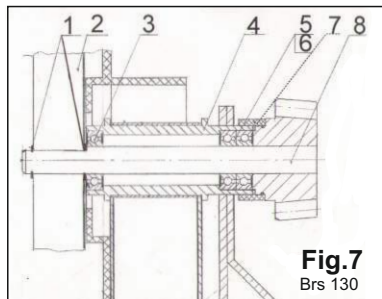

Fig.7
Brs 130

3. Replacement of the lower bearing.

To replace the lower bearing we recommend you to contact your local service of concrete mixer or in repair workshop.

4. The replacement of the fan

4.1. Run p.1.1 of this manual

4.2. Remove the fan from the motor axis

4.3. Using a rubber hammer with the light blows put it on the axis of the engine.

* Completion of the concrete mixer from 2015.

PASSPORT

Concrete mixer BRS - 130 f / n * _____

Concrete mixer BRS - 165 f / n * _____

Concrete mixer BRS - 200 f / n * _____

Meets the requirements 29.5-14261690.001-2004 of Ukraine Specifications

(* Factory number)

CE Declaration of conformity

The producer stamp

Production date / / / /.(day/ month /year)

Sold in working condition and complete set / / / /.(day/ month /year).

Company-seller _____

Information on the warranty repair

Executive organization _____

№	Х-ка несправност	Виконані роботи	Дата

After performing the guarantee repair, warranty lasts only for the replaced spare parts for concrete mixers

Address of the Manufacturer company"Vector-08": Ukraine, 58023 Chernivtsi city O. Pchilka street. b.22. Tel. (380372) 585814, 586

Executive organization _____

e-mail: vp.vector08@gmail.com

www.vector-ua.net